



Accessories

Nozzle assembly\*

For floor  
Part No.

- 127825-8
- 127827-4
- 127828-2



Nozzle assembly

For floor/carpet  
Part No.

- 191X06-4



Nozzle assembly

For floor  
Part No.

- 123486-2
- 123488-8
- 123539-7



Seat Nozzle

Part No.

- 199038-1
- 199041-2
- 199039-9



Flexible hose

Part No. 191E30-3



Flexible hose

Part No.

- 198868-7
- 198545-1
- 198547-7



Sash nozzle\*

Part No.

- 451240-7
- 451243-1
- 413809-5



Long sash nozzle

Part No.

- 198919-6
- 198990-0
- 198992-6



Nozzle holder\*

Part No.

- 459354-6
- 459355-4
- 459038-6



Round brush

Part No.

- 198878-4
- 198553-2
- 198555-8



Crevice nozzle 415

Part No. 199439-3



Shelf brush

Part No.

- 198873-4
- 198538-8
- 198540-1



Straight pipe set 340

For Cyclone attachment set  
Part No.

- 191D76-3
- 191D78-9
- 191D77-1



Straight pipe with pipe lock\*

Part No.

- 459353-8
- 459356-2
- 458942-6



Straight pipe with pipe lock

Part No.

- 1910Y3-1

L: 479-719mm



DCL283F / DCL284F only

Filter set

Part No.  
443060-3



Pre-filter

Part No.  
451208-3



Easy shake off filter B set

Part No.  
199966-0



Filter H set

Part No.  
199989-8

HEPA filter



DCL283F / DCL284F only

Cyclone attachment set with pipe lock

Part No.

- 191D71-3
- 191D73-9



Holder Set

Part No. 199971-7



Tool bag set

Part No. 199901-8

LxWxH:  
600x210x  
190mm



For all 3 models

Cyclone unit set

Part No.

- 1910D3-4
- 1910D5-0



Only for Cyclone unit set

High performance filter set

Part No.  
1910C7-9



Filter H set

Part No.  
1910C9-5

HEPA filter



\*Standard Equipment

Charging Time

	DC18RC	DC18SD
<b>BL1815N</b> 1.5Ah 196449-1	<b>15 min</b>	<b>30 min</b>
<b>BL1820B</b> 2.0Ah 197254-9	<b>24 min</b>	<b>45 min</b>
<b>BL1830B</b> 3.0Ah 197599-5	<b>22 min</b>	<b>60 min</b>
<b>BL1850B</b> 5.0Ah 197280-8	<b>45 min</b>	<b>110 min</b>
<b>BL1860B</b> 6.0Ah 197422-4	<b>55 min</b>	<b>130 min</b>

Cordless Cleaner

DCL283F / DCL284F / DCL286F

	DCL283F	DCL284F	DCL286F
Electronic 4-Speed DCL284F/DCL286F only			
Built-in Job Light			
Capacity	730 mL	730 mL	Cyclone: 250 mL
Continuous Use	w/ BL1830B: 10 min	w/ BL1830B, Mode 1 / 2 / 3 / 4: 38 / 21 / 15 / 8	w/ BL1830B, Mode 1 / 2 / 3 / 4: 38 / 21 / 15 / 8
Max air flow	1.1 m³/min	1.2 m³/min	1.0 m³/min
Max sealed suction	17.5 kPa	18 kPa	18 kPa
Noise level	63 dB(A)	Mode 1 / 2 / 3 / 4: 54 / 60 / 62 / 65 dB(A)	Mode 1 / 2 / 3 / 4: 55 / 60 / 62 / 66 dB(A)
Dimensions (L x W x H)	w/o Pipe & Nozzle, w/ BL1830B: 503 x 113 x 155 mm (19-3/4 x 4-7/16 x 6-1/8")	w/o Pipe & Nozzle, w/ BL1830B: 503 x 113 x 153 mm (19-3/4 x 4-7/16 x 6")	w/o Pipe & Nozzle, w/ BL1830B: 543 x 113 x 177 mm (21-3/8 x 4-7/16 x 7")
	w Pipe & Nozzle, w/ BL1830B: 1,066 x 113 x 155 mm (42 x 4-7/16 x 6-1/8")	w Pipe & Nozzle, w/ BL1830B: 1,066 x 113 x 153 mm (42 x 4-7/16 x 6")	w Pipe & Nozzle, w/ BL1830B: 1,106 x 113 x 177 mm (43-1/2 x 4-7/16 x 7")
Net weight	1.3 - 1.6 kg (2.9 - 3.5 lbs.)	1.3 - 1.6 kg (2.9 - 3.5 lbs.)	1.6 - 1.9 kg (3.5 - 4.2 lbs.)

Standard Equipment : Nozzle assembly, Sash nozzle, Nozzle holder, Straight pipe, Easy shake off filter EX (DCL283F, DCL284F), Easy shake off filter (DCL286F), Battery, Charger

The weight does not include accessories but battery cartridge(s). The lightest and heaviest combination weight of the appliance and battery cartridge(s) are shown in the table. Items of standard equipment and specifications may vary by country or area.

Makita Singapore Pte Ltd

7, Changi South Street 3, Singapore 486348  
Phone : +65-6546-8700 Fax : +65-6546-8711  
Email : msgproductteam@makita.com.sg  
Website : www.makita.com.sg  
Facebook : www.facebook.com/MakitaSG



VISIT OUR WEBSITE



DOWNLOAD LEAFLET

PRINTED IN SINGAPORE



Cordless Cleaner  
DCL283F / DCL284F / DCL286F



photo: DCL286F



DCL283F

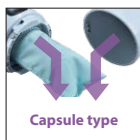

DCL284F

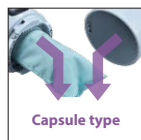

DCL286F

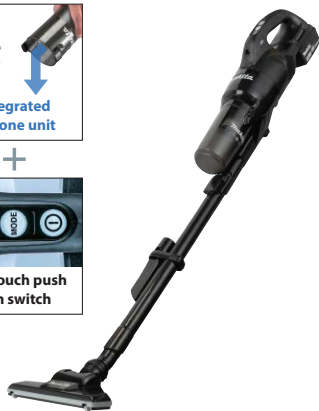





photo: DCL284F

# 18V LXT BL Cordless Cleaner

## Capsule type

Dust capacity **730 mL**



## Improved dust-resistance

When capsule is installed securely, two ribs inside capsule press the inside frame of filter to hold the filter tight.



photo: DCL283F

### DCL283F

Trigger switch

### DCL284F

One-touch push button switch

**HEPA filter**



## Integrated cyclone unit

Dust capacity **250 mL**



## Integrated Cyclone unit

The filter is less clogged due to separation of fine dust through a cyclone air flow, reducing the decrease in vacuum power of cleaner.

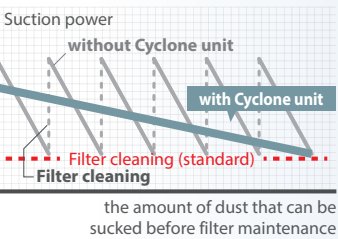

### DCL286F

One-touch push button switch

**Easy filter setting**  
Filter can be fixed with a single push.



## High suction power and Low noise level

- Achieved by redesigning the exhaust air flow path of the motor to reduce wind noise.
- Equipped with high-speed BL motor to ensure high suction power.

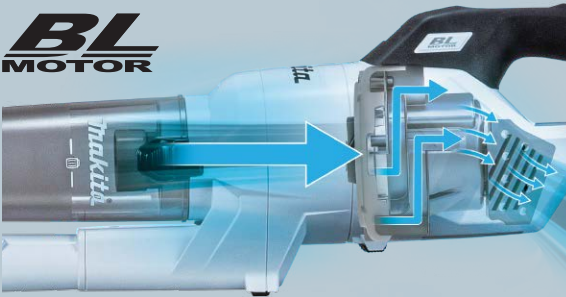

### Low noise

DCL283F

**63 dB(A)**

DCL284F **65** <sup>[Mode 4]</sup> dB(A)

DCL286F **66** <sup>[Mode 4]</sup> dB(A)

## Redesigned Floor/ Carpet T-nozzle

- Redesigned structure reduces the resistance caused by suction, providing smooth running.
- Redesigned inside air flow path reduces the noise made inside the nozzle.



## Trigger switch + Sliding lock-on switch

(DCL283F only)

allows for long continuous cleaning with less fatigue.



By moving ① sliding lock-on switch to ON position, ② interlocking trigger switch can be locked on for continuous cleaning.

## 4-suction power mode selection with mode memory function

(DCL284F / DCL286F only)

- The cleaner can memorize a previous power mode and resume vacuuming at the same mode as last time user turned off for user convenience.
- Power mode can be selected before the cleaner is turned on.

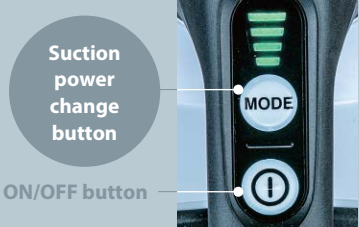

## Single LED job light

also functions as a battery capacity warning lamp.



## Pipe locking mechanism

Pipe is fixed with the locking mechanism to prevent it from accidentally coming off.



## Pipe with beveled end

Cleaning of tight places can be done without nozzle by using the beveled end of pipe as a nozzle.

