





Accessories

Attachments		UX01G (40V max)	DUX60 (18V x2)	DUX18 (18V)
Brushcutter	EM402MP ø230mm Metal blade	●	●	●
Rotary Scissors	EM407MP	●	●	●
Edger	EE400MP	●	●	●
Power brush	BR400MP	●	●	●
Pole saw	EY401MP Cutting wide: 255mm	●	●	●
Blower	UB400MP	●	●	●
	UB401MP Low noise	●	●	●
Grass trimmer	EM408MP(Universal guard) ø420mm Nylon cutting head ø2.0	●	●	●
	EM409MP(Narrow guard) Universal guard Ø420mm / Ø2.0	●	●	●







Attachments		UX01G (40V max)	DUX60 (18V x2)	DUX18 (18V)
Coffee harvester	EJ400MP	●	●	●
Power sweep	SW400MP	●	●	●
Shaft extension attachment	LE400MP	●	●	●
Ground trimmer	EN420MP Angle adjustment	●	●	●
Hedge trimmer	EN401MP Angle adjustment	●	●	●
	EN410MP Straight	●	●	●
Cultivator	KR400MP 220mm	●	●	●
	KR401MP 160mm	●	●	●

Portable Power Pack

Portable Power Pack			Adapter set	Model
PDC1200	Equipped with built-in battery cells		40Vmax 191N62-4	UX01G
			18Vx2 191J51-5	DUX60
PDC01	Powered by up to four 18V LXT batteries		18V 191J50-7	DUX18
				

Cordless Multi Function Power Head

DUX18 / DUX60 / UX01G

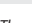
	UX01G	DUX60	DUX18
 Variable Speed	High: 0 - 9,700	High: 0 - 9,700	High: 0 - 9,700
 Brake	Medium: 0 - 8,200	Medium: 0 - 8,200	Low: 0 - 6,800
 Reversing (DUX60 / UX01G)	Low: 0 - 5,700	Low: 0 - 5,700	
 Electronic 2-Speed (DUX18)	1.0 kW	0.6 kW	0.47 kW
 Electronic 3-Speed (DUX60 / UX01G)	Dimensions (L x W x H) 1,027 x 320 x 209 mm (40-1/4 x 12-5/8 x 8-1/4")	983 x 318 x 175 mm (38-3/4 x 12-1/2 x 6-7/8")	
 Constant Speed	Net weight 4.2 - 4.8 kg (9.3 - 10.6 lbs.)	4.1 - 4.7 kg (8.9 - 10.3 lbs.)	2.8 - 3.1 kg (6.2 - 6.8 lbs.)
 Soft Start	Standard Equipment: Harness, Safety Goggles, Hex Wrench, Accessory Bag, Tool bag (for spec with Brushcutter attachment only), Carbide-Tipped Saw Blade (for spec with EM402MP only), Box Wrench (for spec with EM402MP only), Metal blade fixing tool (Clamp washer, Nut, Cup) (for spec with EM402MP only), Battery, Charger		

The weight may differ depending on the attachment(s), including the battery cartridge. The lightest and heaviest combination, according to EPTA-Procedure 01/2014, are shown in the table. Items of standard equipment and specifications may vary by country or area.

Makita Singapore Pte Ltd

7, Changi South Street 3, Singapore 486348
Phone : +65-6546-8700 Fax : +65-6546-8711
Email : msgproductteam@makita.com.sg
Website : www.makita.com.sg
Facebook : www.facebook.com/MakitaSG



MakitaSG



VISIT OUR WEBSITE



DOWNLOAD LEAFLET

PRINTED IN SINGAPORE



Cordless Multi Function Power Head Series UX01G / DUX60 / DUX18

Satisfy Professional's Needs





UX01G

40Vmax

Max output
UX01G
1.0kw



DUX60

18V + 18V → 36V

Max output
DUX60
0.6kw



DUX18

18V LITHIUM-ION

Max output
DUX18
0.47kw





**BL
MOTOR**

**High Power
BL Motor**



High power BL motor allows for more comfortable operation in rather heavy-duty application using an attachment such as power brush, power sweep, blower, etc.



UX01G **NEW**



Li-ion (Ah)
2.0 2.5 4.0 5.0

Max output
1.0kW

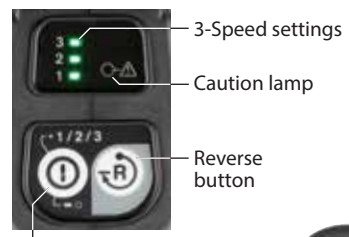

ON / OFF button

Caution lamp

Overload

Overheat

Overdischarge



**WG
WETGUARD**
High water-resistance allows to operate the machine even if it is wet with water.



DUX60

18v + 18v → 36v

Li-ion (Ah)
1.5 2.0 3.0 4.0 5.0 6.0

Max output
0.6kW

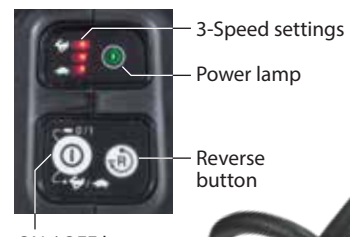

ON / OFF button



XPT
eXtreme Protection
Technology

DUX18 **NEW**

18v
LITHIUM-ION

Li-ion (Ah)
1.5 2.0 3.0 4.0 5.0 6.0

Max output
0.47kW

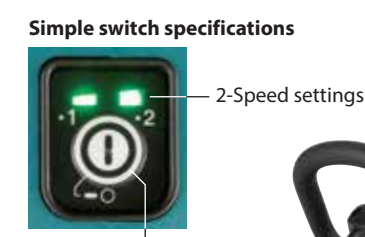

ON / OFF button



XPT
eXtreme Protection
Technology

Features



Reverse button for easy removal of grass clippings from the cutting tool (UX01G / DUX60 only)

Grass clippings can be removed by slow reverse rotation of the cutting tool. After 1.5 seconds, machine stops. Switch position will be returned back to "Forward" automatically after stopping.



Easy change

Lever style lock system allows for quick toolless installation and replacement of the attachments.

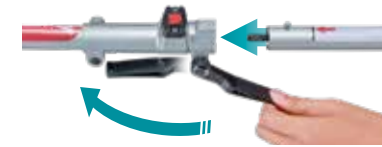

Excellent portability

- Split system of Power head and Attachment provides easier portability.
- Optional tool bag makes it even easier to transport Power head and Attachment and to put them into car trunk or small storage space.



AFT

Active Feedback sensing Technology

- If kickback occurs while using below attachment, brake works automatically:
 - 1) Brushcutter with metal blade attachment
 - 2) Pole saw attachment
- If the sensor detects drastically decrease of rotation, the motor stops immediately.

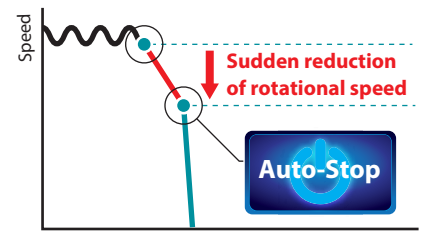

Optional attachments



Brushcutter
EM400MP / EM402MP
195658-9 / 195952-9



Rotary Scissors
EM407MP
191M60-2



Edger
EE400MP
196750-4



Pole saw
EY401MP
199925-4



Hedge trimmer
Straight: EN410MP / 197742-6
Angle adjustment: EN401MP / 196341-1



Ground trimmer
EN420MP
198061-3



Cultivator
KR400MP / KR401MP
195712-9 / 195716-1



Coffee harvester
EJ400MP
195726-8
197163-2

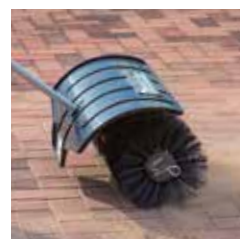

Power brush
BR400MP
199323-2



Power sweep
SW400MP
199344-4



Blower
UB400MP / UB401MP
191F72-3 / 191P78-1



Shaft extension attachment
LE400MP
191E23-0

1,080 mm

For Pole saw, Pole hedge trimmer and Coffee harvester



Grass trimmer
EM408MP
191N35-7
EM409MP
191N48-8

*UX01G / DUX60 only