



**Dust extraction system**

**Compatible with long bits**  
Dust collection is available for bits with an overall length of up to 265mm.

**Depth gauge for increased drilling consistency**

**Equipped with HEPA Filter**  
which removes particles with an efficiency rating of 99.75% from the air passing through.

**HEPA filter**

**Filter cleaning mechanism**  
by turning the dial, the dust falls from the filter

**Transparent dust case**  
for easy checking of collected dust amount

**Easy disposal of dust and easy cleaning of dust case**  
thanks to:  
• Dust case cover easy to open/ close with a single operation of a locking tab  
• Wide opening of dust case

**Dust case body is equipped with a fan for dust collection.**

Photo: HR008G+DX10

**Accessories**

**Dust case set**  
for DX11 / DX10  
Part No. 191F49-8

**Filter set**  
Part No. 199557-7

**Dust cup set**  
for HR008G  
Part No. 195173-3  
for HR009G  
Part No. 195179-1

**Drill chuck set**  
for HR009G  
Part No. 191F46-4

**Tool holder set**  
for HR009G  
Part No. 191F47-2

**Spacer set**  
for HR008G  
Part No. 191L91-5

**Dust cup**  
Bit dia: 14.5mm  
Part No. 421342-3

**Hook set**  
Part No. 191W90-3

**Charging Time**

	Fast Charging DC40RA	DC40RC
<b>BL4020</b> 2.0Ah 191L29-0	22 min	30 min
<b>BL4025</b> 2.5Ah 191B36-3	28 min	38 min
<b>BL4040</b> 4.0Ah 191B26-6	45 min	67 min
<b>BL4050F</b> 5.0Ah 191L47-8	50 min	85 min
<b>BL4080F</b> 8.0Ah	76 min	170 min

\*1 Recommended battery

**Cordless Combination Hammer**  
**HR008G / HR009G** 30 mm (1-3/16") Adapted for SDS-PLUS bits

	HR008G	HR009G
Variable Speed	3.9 J	3.9 J
Brake	Concrete (w/ TCT Bit): 30 mm (1-3/16"), Steel: 13 mm (1/2"), Wood: 32 mm (1-1/4") Core Bit: 80 mm (3-1/8")	Concrete (w/ TCT Bit): 30 mm, Steel: 13 mm (1/2"), Wood: 32 mm (1-1/4") Core Bit: 80 mm (3-1/8")
Reversing	0 - 4,500	0 - 4,500
SDS-PLUS Shank	No Load Speed (RPM) 0 - 840	No Load Speed (RPM) 0 - 840
Torque Limiter	Chuck Capacity 1.5 - 13 mm (1/16 - 1/2")	Chuck Capacity 1.5 - 13 mm (1/16 - 1/2")
Constant Speed	Sound Pressure Level 94 dB(A)	Sound Pressure Level 94 dB(A)
Dust Collection	Sound Power Level 105 dB(A)	Sound Power Level 105 dB(A)
Built-in Job Light	Vibration Level Hammer Drilling into Concrete: 9.1 m/s <sup>2</sup>	Vibration Level Hammer Drilling into Concrete: 9.1 m/s <sup>2</sup>
	Dimensions (L x W x H) w/ BL4040: 422 x 97 x 242 mm (16-5/8 x 3-13/16 x 9-1/2")	Dimensions (L x W x H) w/ BL4040: 439 x 97 x 242 mm (17-1/4 x 3-13/16 x 9-1/2")
	w/ BL4050F: 441 x 97 x 263 mm (17-3/8 x 3-13/16 x 10-3/8")	w/ BL4050F: 457 x 97 x 263 mm (18 x 3-13/16 x 10-3/8")
	Net weight 5.2 - 6.8 kg (11.5 - 15.0 lbs.)	Net weight 5.3 - 6.7 kg (11.7 - 14.8 lbs.)

**Standard Equipment** HR008G: Side grip, Depth Gauge, Battery, Charger  
HR009G: Quick Change Drill Chuck, Side grip, Depth Gauge, Battery, Charger

The weight may differ depending on the attachment(s), including the battery cartridge. The lightest and heaviest combination, according to EPTA-Procedure 01/2014, are shown in the table. Items of standard equipment and specifications may vary by country or area.

**Makita Singapore Pte Ltd**  
7, Changi South Street 3, Singapore 486348  
Phone : +65-6546-8700 Fax : +65-6546-8711  
Email : msgproductteam@makita.com.sg  
Website : www.makita.com.sg  
Facebook : www.facebook.com/MakitaSG



VISIT OUR WEBSITE

DOWNLOAD LEAFLET

PRINTED IN SINGAPORE



Photo: HR008G+DX10

Impact energy  
[EPTA-Procedure 05/2009]  
**3.9**  
Joule

**HR008G**



**Dust extraction system DX10 (option)** Part No. 191F95-1

**HEPA filter**



**HR009G**



**Quick change drill chuck**



**Dust extraction system DX11 (option)** Part No. 191G01-2

**HEPA filter**



# AVT Anti-Vibration Technology



## BL MOTOR

High efficiency  
Brushless DC motor



## Constant speed control

minimizes the reduction in bit speed to provide stable drilling.

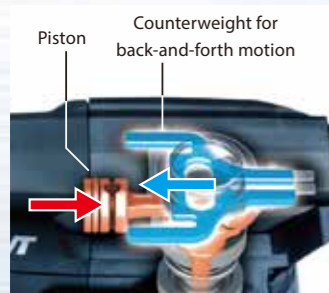
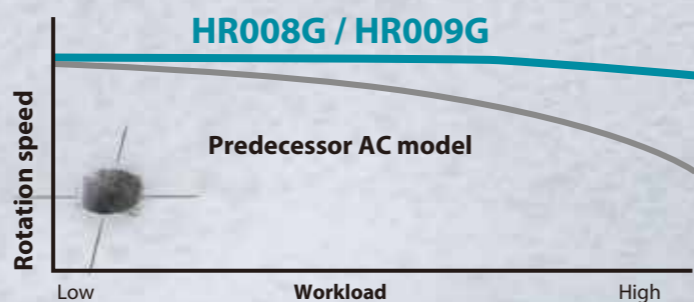

### Counterweight for back-and-forth motion

Counterweight to cancel the back-and-forth vibration caused by hammering

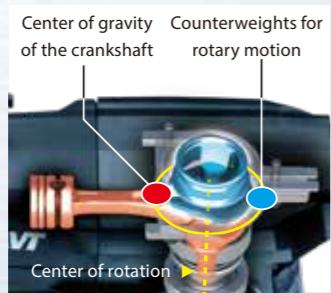

### Counterweights for rotary motion

Counterweight to cancel the vibration caused by imbalanced rotation of crankshaft

# AFT Active Feedback sensing Technology

turns the motor off if bit rotation is suddenly forced to stop.

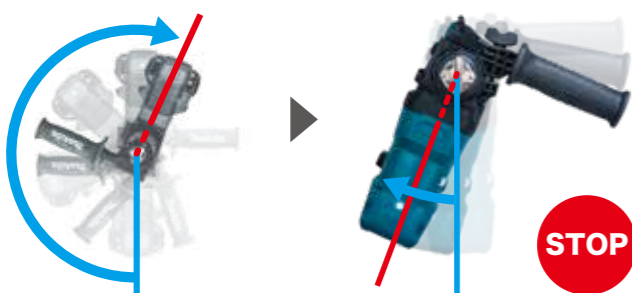

# AWS Auto-start Wireless System

connects to compatible vacuum cleaner with Bluetooth. The vacuum cleaner automatically runs while the switch is on.

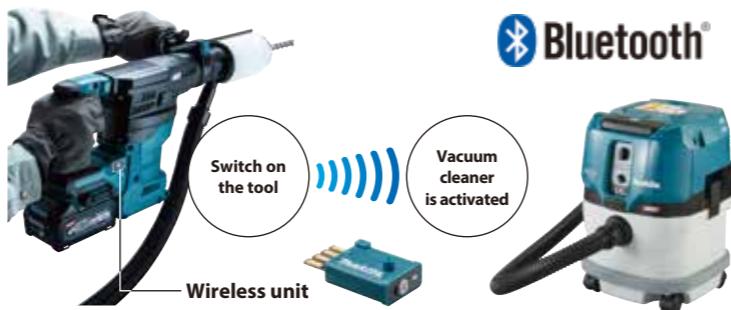

# XPT eXtreme Protection Technology



Photo: HR008G

Drilling performance		
Drilled holes to a depth of 60mm (2-3/8") at 10kg pressing load Concrete with compressive strength of 40N/mm <sup>2</sup> BL4040 / on full battery charge		
Work speed		
ø10.5mm (3/8")	ø16.0mm (5/8)	ø20.0mm (13/16")
<b>5.0</b> sec	<b>9.1</b> sec	<b>17.1</b> sec
Work amount		
ø10.5mm (3/8")	ø16.0mm (5/8)	ø20.0mm (13/16")
<b>109</b> pcs	<b>59</b> pcs	<b>35</b> pcs

Photo: HR008G+DX10